

1/20/2023 8:42:30 AM
USP: P:\mtdt\111\020321.dwg
USP: CAD DATA

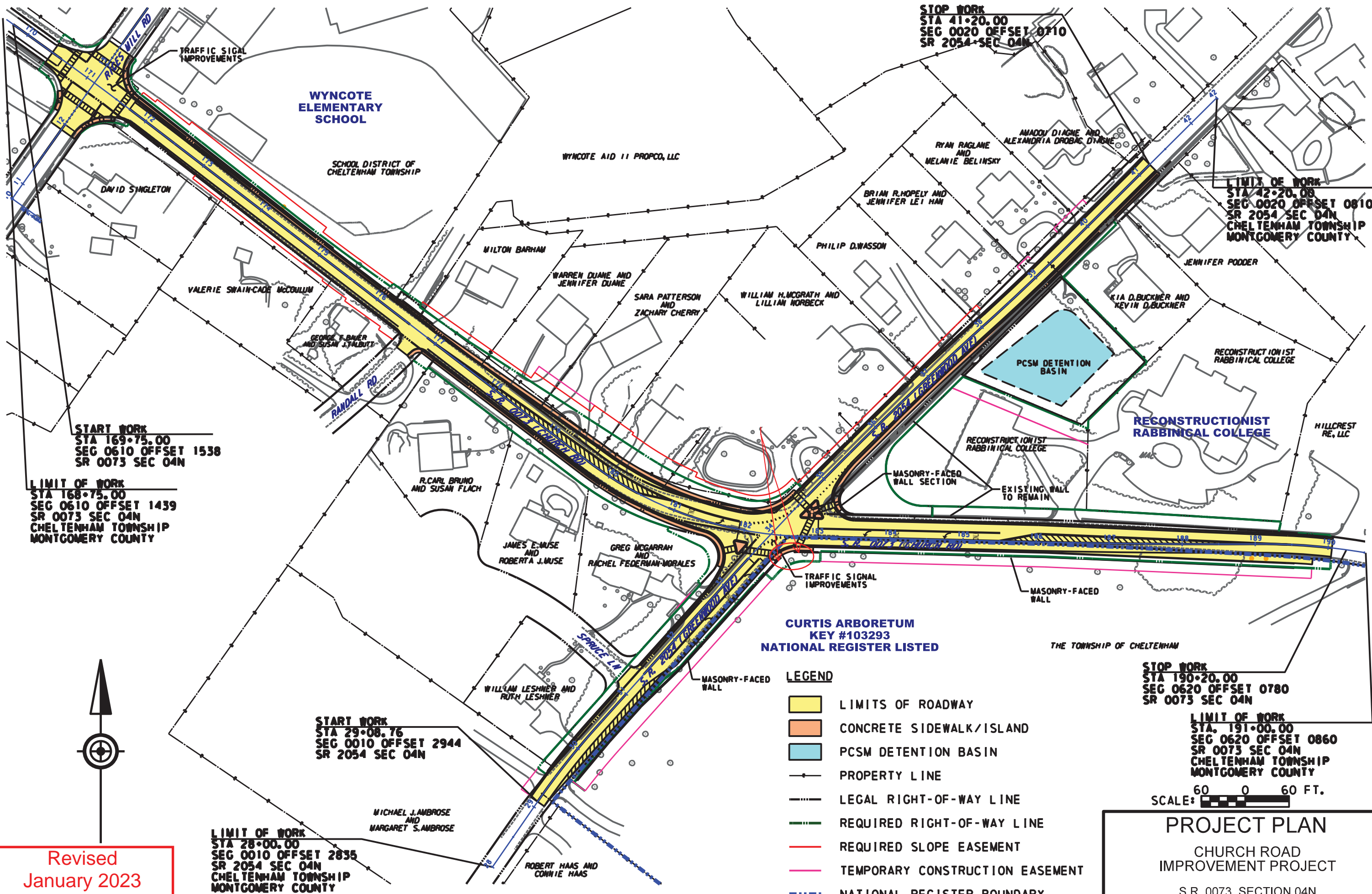

STOP WORK
STA 41+20.00
SEG 0020 OFFSET 0710
SR 2054-SEC 04N

LIMIT OF WORK
STA 42+20.00
SEG 0020 OFFSET 0810
SR 2054-SEC 04N
CHELTENHAM TOWNSHIP
MONTGOMERY COUNTY

START WORK
STA 169+75.00
SEG 0610 OFFSET 1538
SR 0073 SEC 04N

LIMIT OF WORK
STA 168+75.00
SEG 0610 OFFSET 1439
SR 0073 SEC 04N
CHELTENHAM TOWNSHIP
MONTGOMERY COUNTY









START WORK
STA 29+08.76
SEG 0010 OFFSET 2944
SR 2054 SEC 04N

LIMIT OF WORK
STA 28+00.00
SEG 0010 OFFSET 2835
SR 2054 SEC 04N
CHELTENHAM TOWNSHIP
MONTGOMERY COUNTY

STOP WORK
STA 190+20.00
SEG 0620 OFFSET 0780
SR 0073 SEC 04N

LIMIT OF WORK
STA 191+00.00
SEG 0620 OFFSET 0860
SR 0073 SEC 04N
CHELTENHAM TOWNSHIP
MONTGOMERY COUNTY

LEGEND

-  LIMITS OF ROADWAY
-  CONCRETE SIDEWALK/ISLAND
-  PCSM DETENTION BASIN
-  PROPERTY LINE
-  LEGAL RIGHT-OF-WAY LINE
-  REQUIRED RIGHT-OF-WAY LINE
-  REQUIRED SLOPE EASEMENT
-  TEMPORARY CONSTRUCTION EASEMENT
-  NATIONAL REGISTER BOUNDARY

SCALE:  60 0 60 FT.

PROJECT PLAN

CHURCH ROAD
IMPROVEMENT PROJECT

S.R. 0073, SECTION 04N

Revised
January 2023