

SECTION 8 - NORTHBOUND
 STATION 199+05 TO STATION 209+05
 HALF WIDTH CONSTRUCTION
 DETOUR LENGTH - 1.10 MILE

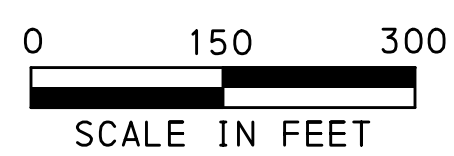
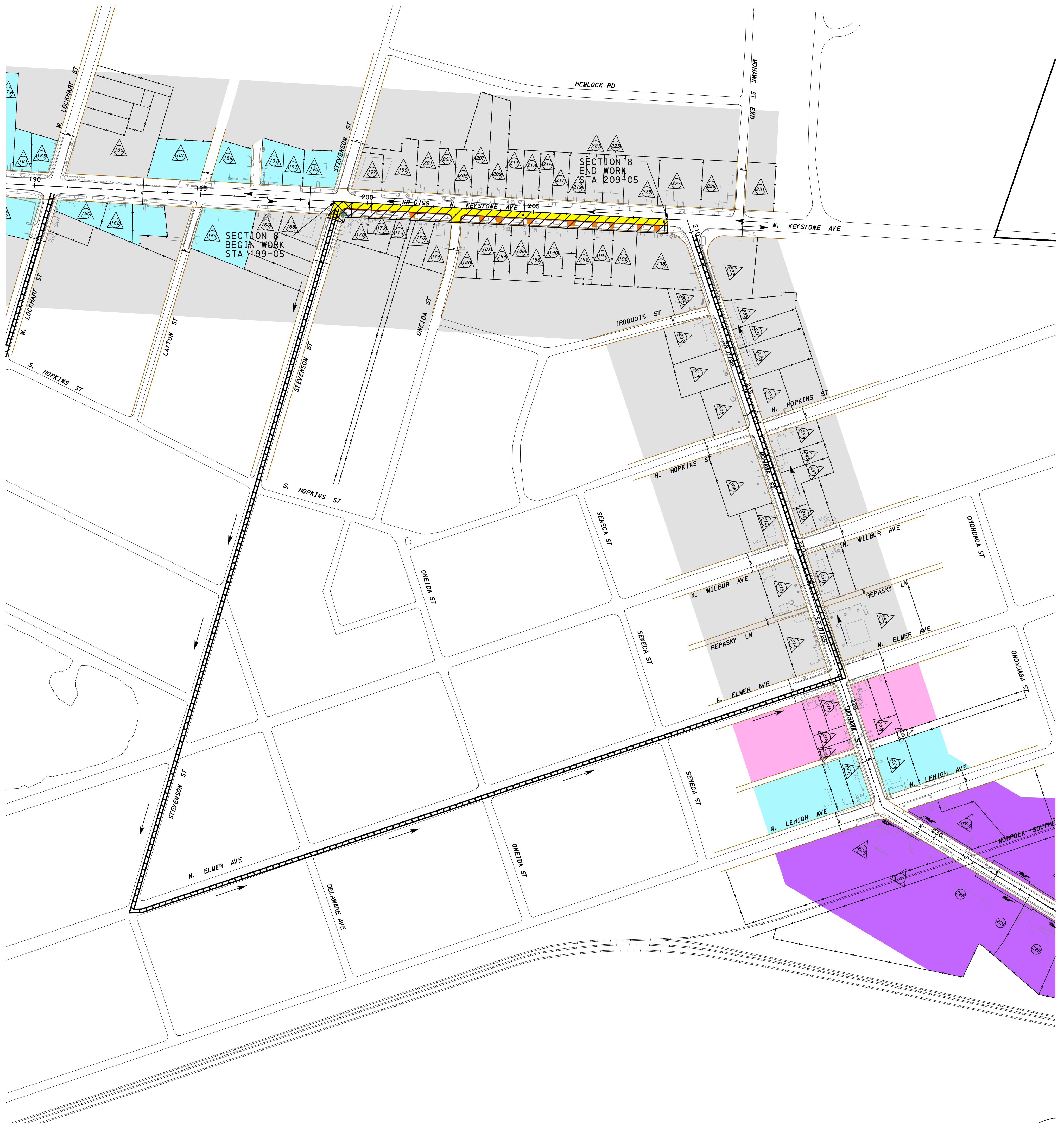
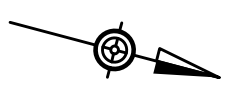

LEGEND

- | | | | | | | | |
|--|---|--|--------------------------|--|--------------------------|--|------------------------|
| | POST MOUNTED SIGN (TYPE B/TEMP) | | FLOW ARROW | | PUBLIC / EDUCATION USE | | SIDEWALKS |
| | SIGN ON TYPE III BARRICADE | | WORK AREA (HALF WIDTH) | | MULTI-FAMILY RESIDENTIAL | | ADA RAMPS |
| | SIGN ID | | WORK AREA (SHORT-TERM) | | HIGHWAY COMMERCIAL | | LEGAL RIGHT OF WAY |
| | EXTEND TYPE III BARRICADES ACROSS PORTION OF ROADWAY TO BE CLOSED | | LIGHT COMMERCIAL / MIXED | | ROADWAY RECONSTRUCTION | | TRAFFIC SIGNAL UPGRADE |
| | DETOUR ROUTE | | RESIDENTIAL | | DRIVEWAY ADJUSTMENTS | | |

SECTION 8 - SOUTHBOUND
 STATION 199+05 TO STATION 209+05
 HALF WIDTH CONSTRUCTION
 DETOUR LENGTH - 1.10 MILE

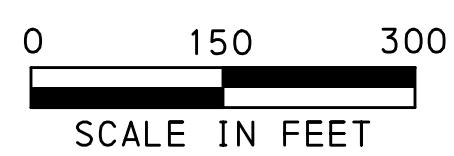
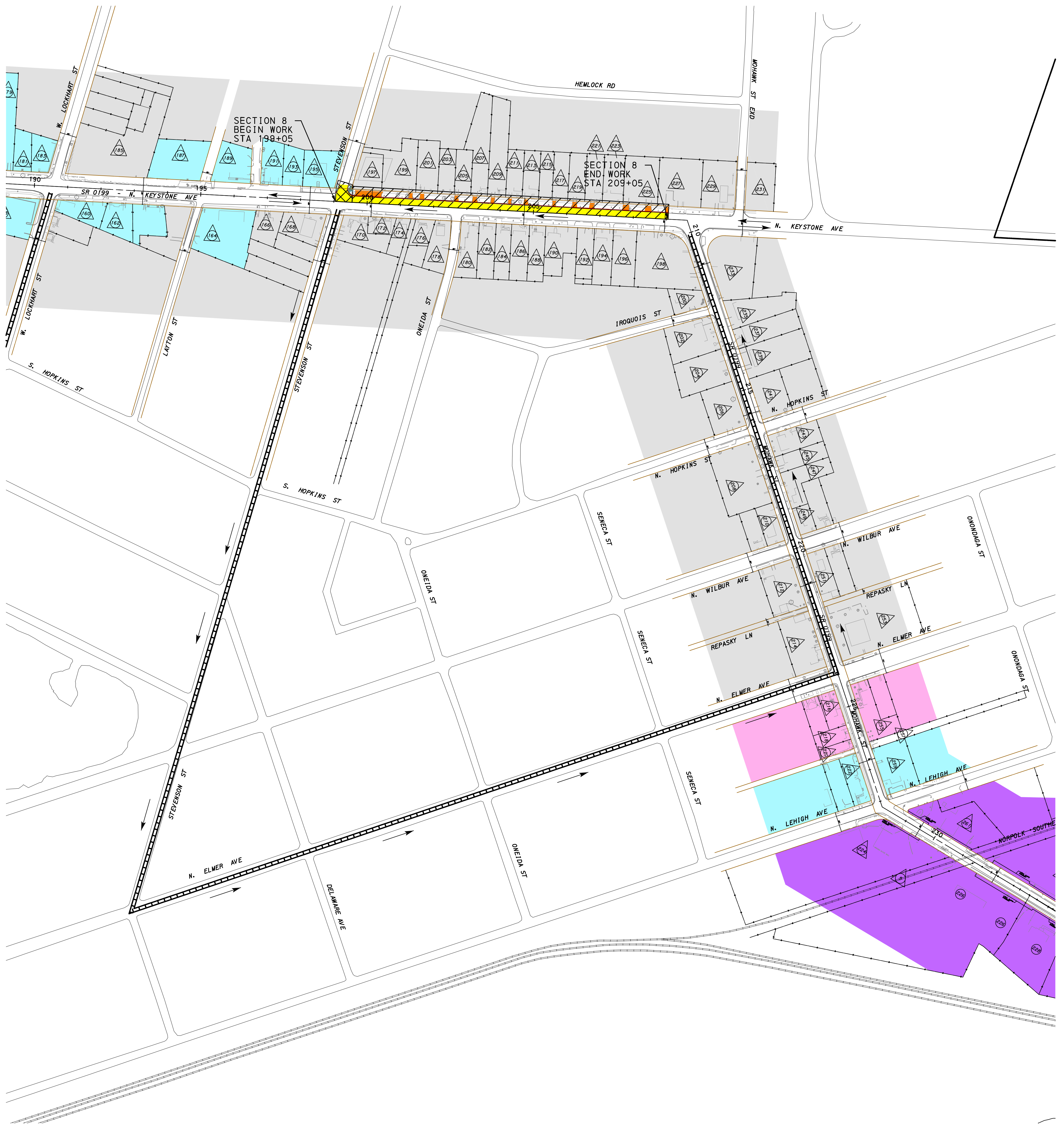
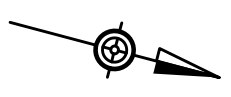

LEGEND

- | | | | | | | | |
|--|---|--|--------------------------|--|--------------------------|--|------------------------|
| | POST MOUNTED SIGN (TYPE B/TEMP) | | FLOW ARROW | | PUBLIC / EDUCATION USE | | SIDEWALKS |
| | SIGN ON TYPE III BARRICADE | | WORK AREA (HALF WIDTH) | | MULTI-FAMILY RESIDENTIAL | | ADA RAMPS |
| | SIGN ID | | WORK AREA (SHORT-TERM) | | HIGHWAY COMMERCIAL | | LEGAL RIGHT OF WAY |
| | EXTEND TYPE III BARRICADES ACROSS PORTION OF ROADWAY TO BE CLOSED | | LIGHT COMMERCIAL / MIXED | | ROADWAY RECONSTRUCTION | | TRAFFIC SIGNAL UPGRADE |
| | DETOUR ROUTE | | RESIDENTIAL | | DRIVEWAY ADJUSTMENTS | | |

SECTION 9 - NORTHBOUND
 STATION 209+05 TO STATION 216+47
 HALF WIDTH CONSTRUCTION
 DETOUR LENGTH - 0.98 MILE

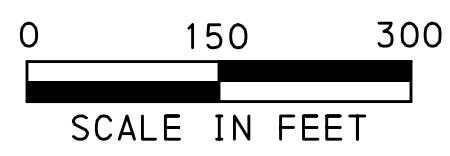
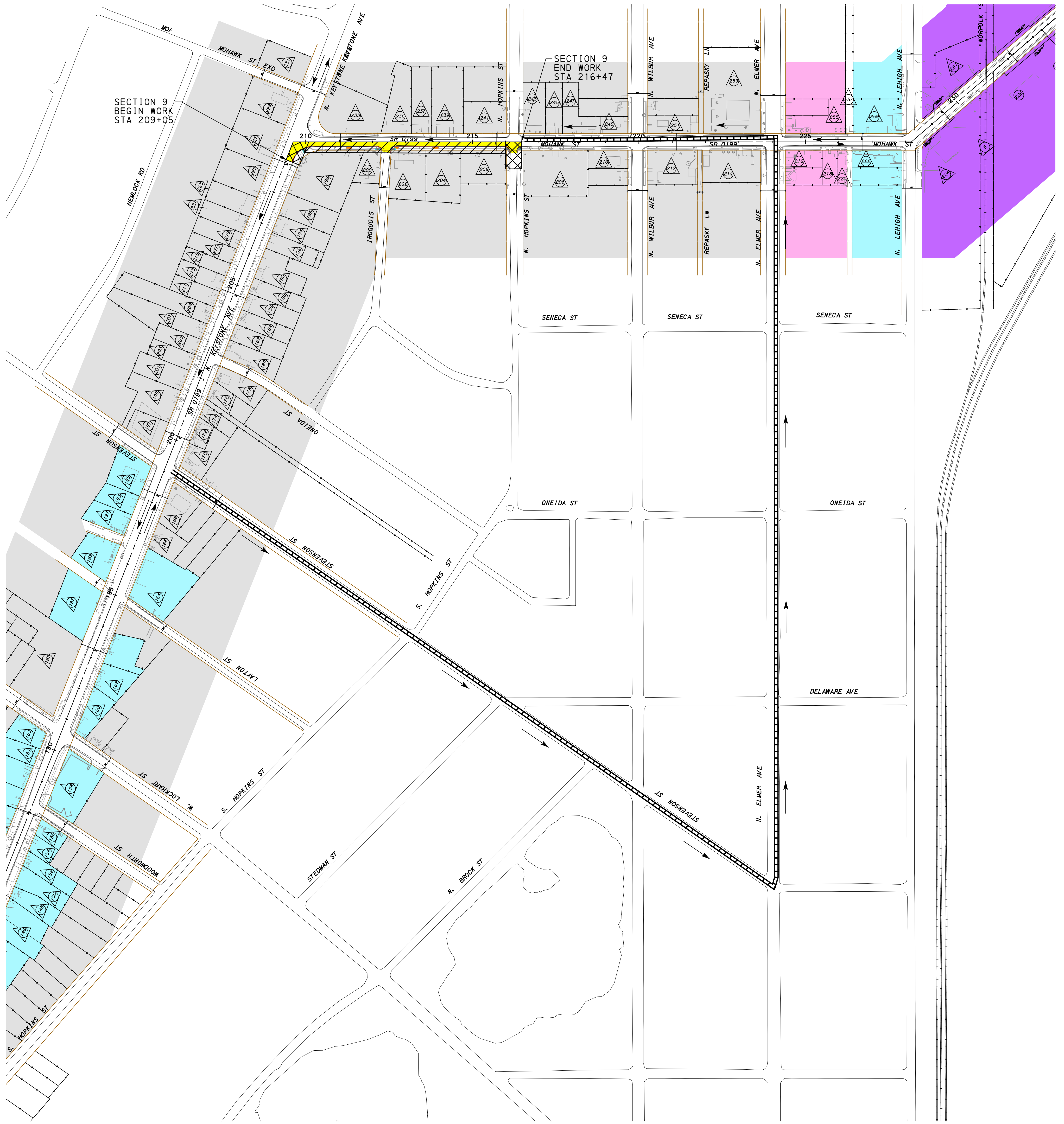

LEGEND

- | | | | | | | | |
|--|---|--|--------------------------|--|--------------------------|--|------------------------|
| | POST MOUNTED SIGN (TYPE B/TEMP) | | FLOW ARROW | | PUBLIC / EDUCATION USE | | SIDEWALKS |
| | SIGN ON TYPE III BARRICADE | | WORK AREA (HALF WIDTH) | | MULTI-FAMILY RESIDENTIAL | | ADA RAMPS |
| | SIGN ID | | WORK AREA (SHORT-TERM) | | HIGHWAY COMMERCIAL | | LEGAL RIGHT OF WAY |
| | EXTEND TYPE III BARRICADES ACROSS PORTION OF ROADWAY TO BE CLOSED | | LIGHT COMMERCIAL / MIXED | | ROADWAY RECONSTRUCTION | | TRAFFIC SIGNAL UPGRADE |
| | DETOUR ROUTE | | RESIDENTIAL | | DRIVEWAY ADJUSTMENTS | | |

SECTION 9 - SOUTHBOUND
 STATION 209+05 TO STATION 216+47
 HALF WIDTH CONSTRUCTION
 DETOUR LENGTH - 0.98 MILE

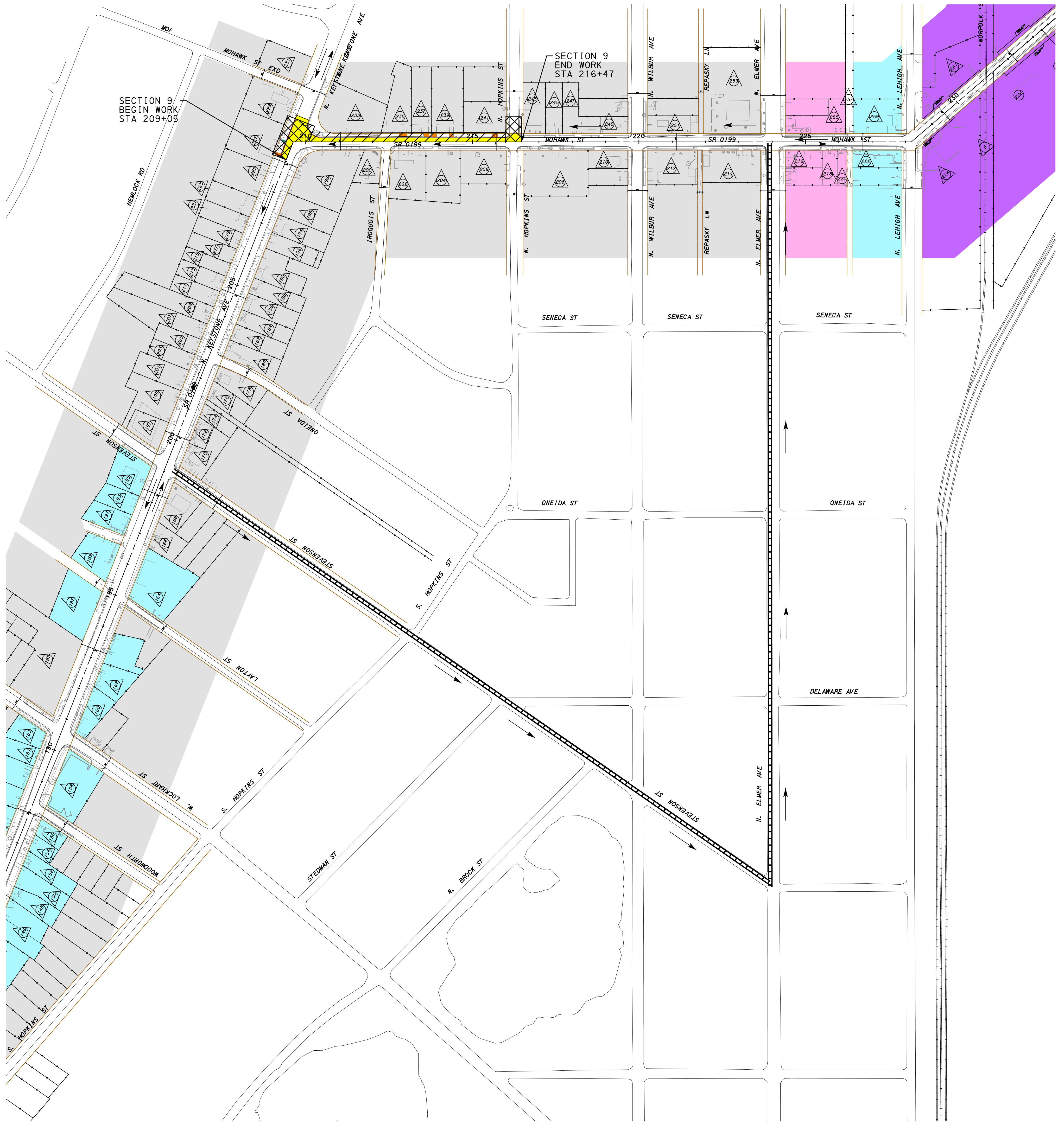

LEGEND

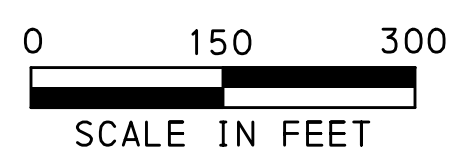

- | | | | | | | | |
|--|---|--|--------------------------|--|--------------------------|--|------------------------|
| | POST MOUNTED SIGN (TYPE B/TEMP) | | FLOW ARROW | | PUBLIC / EDUCATION USE | | SIDEWALKS |
| | SIGN ON TYPE III BARRICADE | | WORK AREA (HALF WIDTH) | | MULTI-FAMILY RESIDENTIAL | | ADA RAMPS |
| | SIGN ID | | WORK AREA (SHORT-TERM) | | HIGHWAY COMMERCIAL | | LEGAL RIGHT OF WAY |
| | EXTEND TYPE III BARRICADES ACROSS PORTION OF ROADWAY TO BE CLOSED | | LIGHT COMMERCIAL / MIXED | | ROADWAY RECONSTRUCTION | | TRAFFIC SIGNAL UPGRADE |
| | DETOUR ROUTE | | RESIDENTIAL | | DRIVEWAY ADJUSTMENTS | | |

SECTION 10 - NORTHBOUND
 STATION 216+47 TO STATION 228+62
 HALF WIDTH CONSTRUCTION
 DETOUR LENGTH - 1.09 MILE

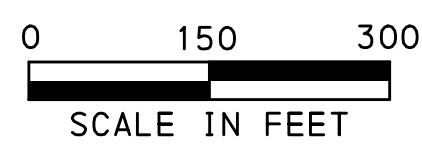
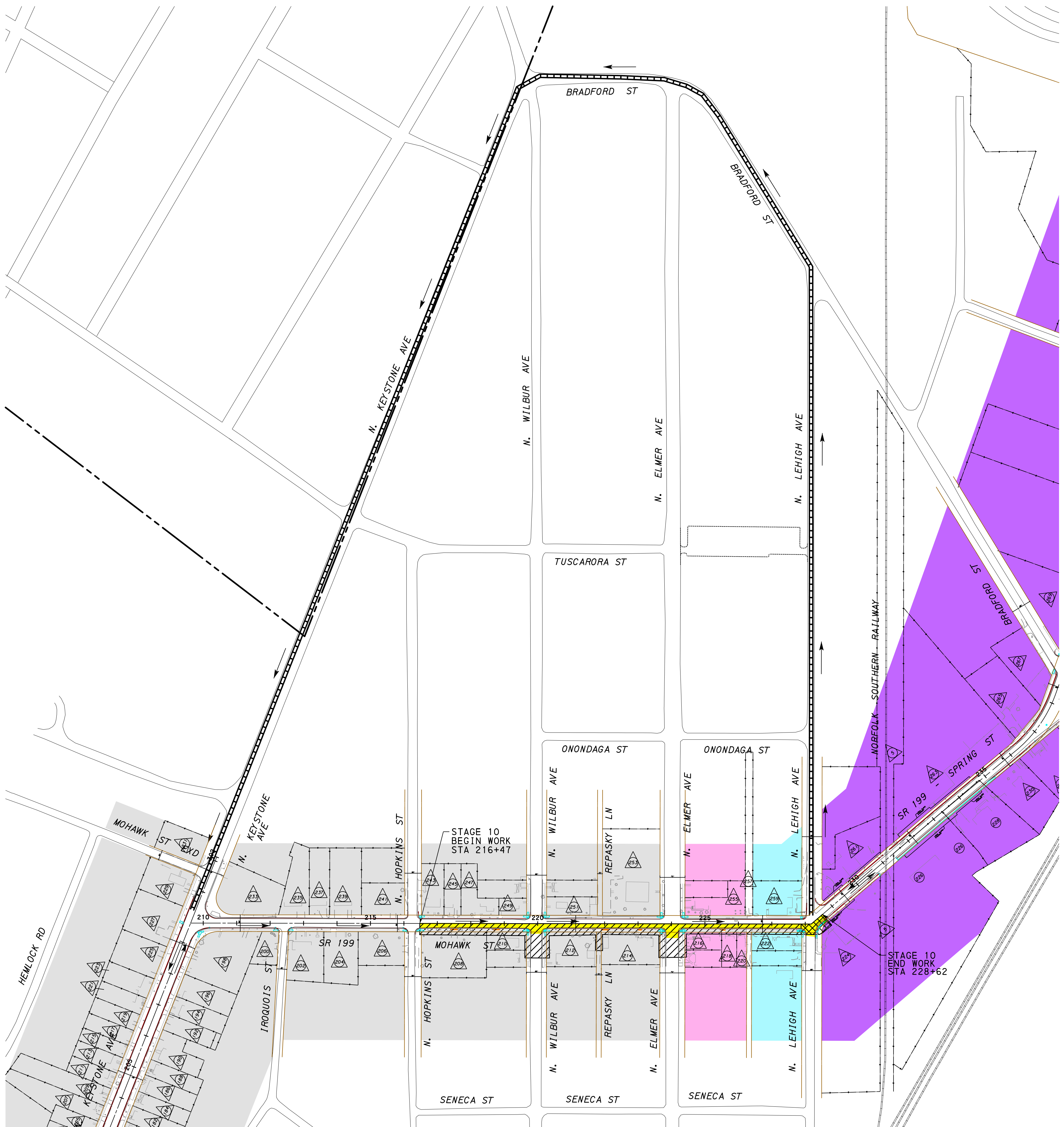
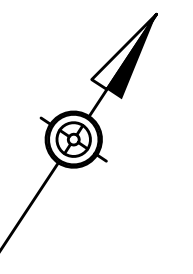

LEGEND

- | | | | | | | | |
|--|---|--|--------------------------|--|--------------------------|--|------------------------|
| | POST MOUNTED SIGN (TYPE B/TEMP) | | FLOW ARROW | | PUBLIC / EDUCATION USE | | SIDEWALKS |
| | SIGN ON TYPE III BARRICADE | | WORK AREA (HALF WIDTH) | | MULTI-FAMILY RESIDENTIAL | | ADA RAMPS |
| | SIGN ID | | WORK AREA (SHORT-TERM) | | HIGHWAY COMMERCIAL | | LEGAL RIGHT OF WAY |
| | EXTEND TYPE III BARRICADES ACROSS PORTION OF ROADWAY TO BE CLOSED | | LIGHT COMMERCIAL / MIXED | | ROADWAY RECONSTRUCTION | | TRAFFIC SIGNAL UPGRADE |
| | DETOUR ROUTE | | RESIDENTIAL | | DRIVEWAY ADJUSTMENTS | | |

SECTION 10 - SOUTHBOUND
 STATION 216+47 TO STATION 228+62
 HALF WIDTH CONSTRUCTION
 DETOUR LENGTH - 1.09 MILE

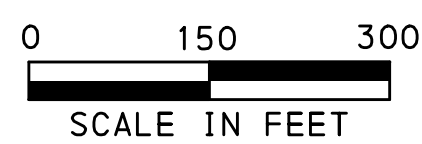
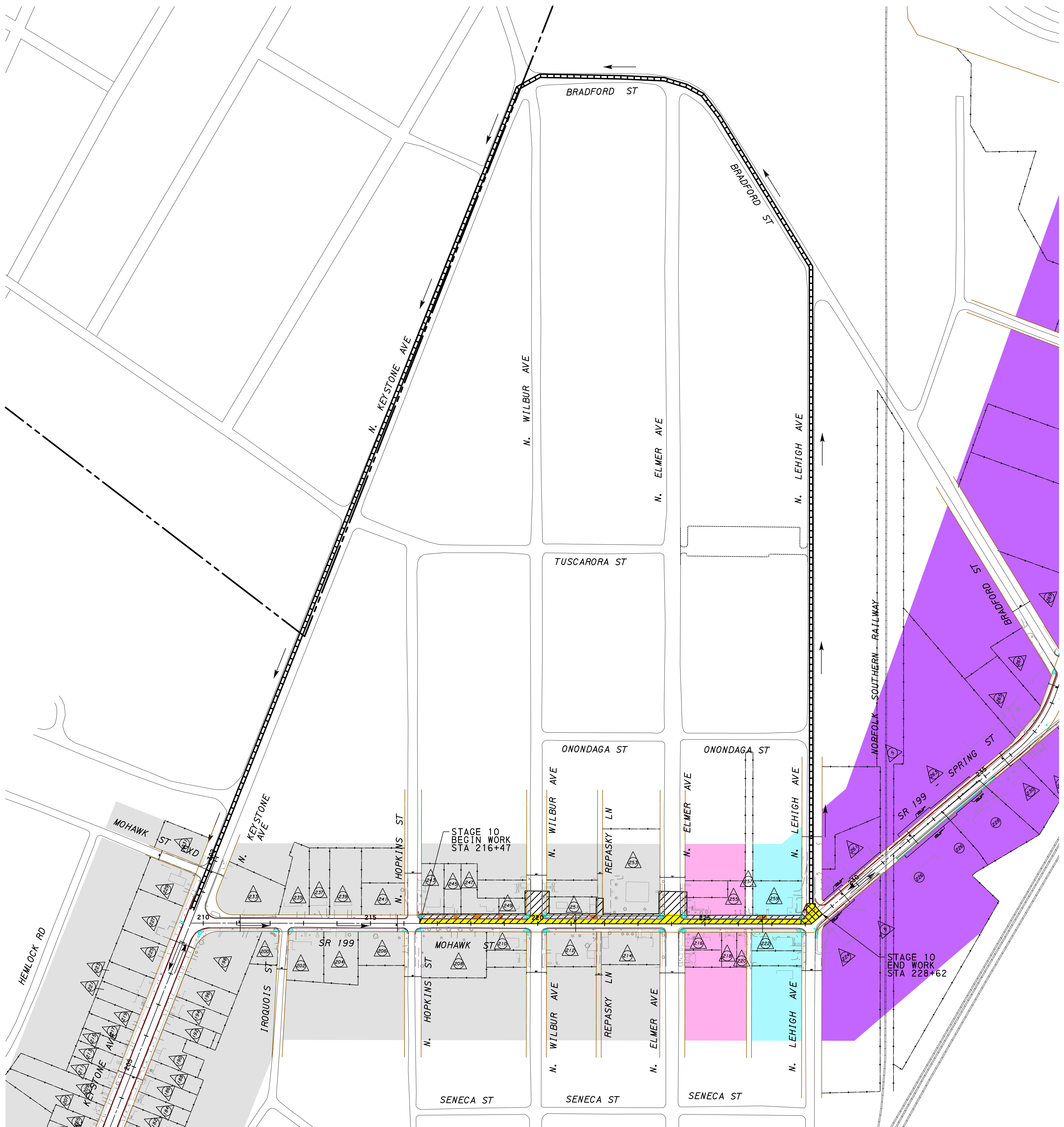
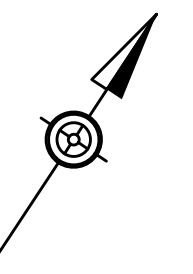

LEGEND

- | | | | | | | | |
|--|---|--|--------------------------|--|--------------------------|--|------------------------|
| | POST MOUNTED SIGN (TYPE B/TEMP) | | FLOW ARROW | | PUBLIC / EDUCATION USE | | SIDEWALKS |
| | SIGN ON TYPE III BARRICADE | | WORK AREA (HALF WIDTH) | | MULTI-FAMILY RESIDENTIAL | | ADA RAMPS |
| | SIGN ID | | WORK AREA (SHORT-TERM) | | HIGHWAY COMMERCIAL | | LEGAL RIGHT OF WAY |
| | EXTEND TYPE III BARRICADES ACROSS PORTION OF ROADWAY TO BE CLOSED | | LIGHT COMMERCIAL / MIXED | | ROADWAY RECONSTRUCTION | | TRAFFIC SIGNAL UPGRADE |
| | DETOUR ROUTE | | RESIDENTIAL | | DRIVEWAY ADJUSTMENTS | | |

SECTION 11 - NORTHBOUND
 STATION 228+62 TO STATION 238+62
 HALF WIDTH CONSTRUCTION
 DETOUR LENGTH - 0.87 MILE

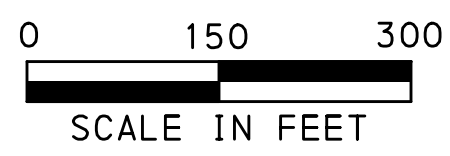
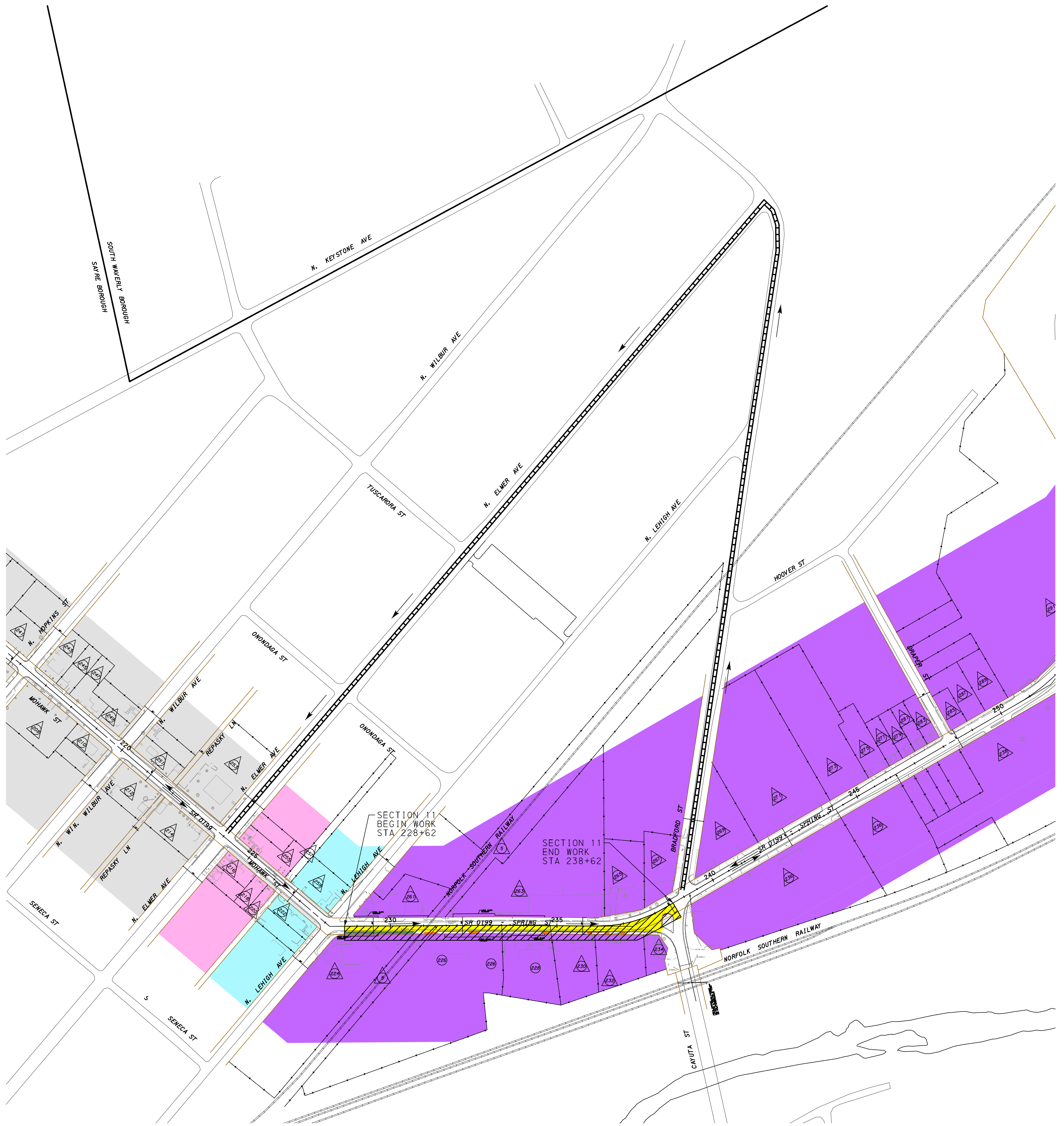
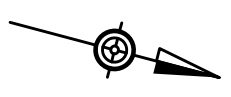

LEGEND

- | | | | | | | | |
|--|---|--|--------------------------|--|--------------------------|--|------------------------|
| | POST MOUNTED SIGN (TYPE B/TEMP) | | FLOW ARROW | | PUBLIC / EDUCATION USE | | SIDEWALKS |
| | SIGN ON TYPE III BARRICADE | | WORK AREA (HALF WIDTH) | | MULTI-FAMILY RESIDENTIAL | | ADA RAMPS |
| | SIGN ID | | WORK AREA (SHORT-TERM) | | HIGHWAY COMMERCIAL | | LEGAL RIGHT OF WAY |
| | EXTEND TYPE III BARRICADES ACROSS PORTION OF ROADWAY TO BE CLOSED | | LIGHT COMMERCIAL / MIXED | | ROADWAY RECONSTRUCTION | | TRAFFIC SIGNAL UPGRADE |
| | DETOUR ROUTE | | RESIDENTIAL | | DRIVEWAY ADJUSTMENTS | | |

SECTION 11 - SOUTHBOUND
 STATION 228+62 TO STATION 238+62
 HALF WIDTH CONSTRUCTION
 DETOUR LENGTH - 0.87 MILE

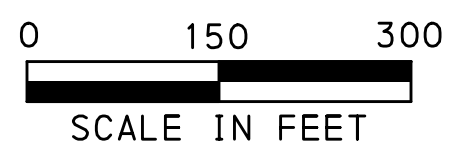
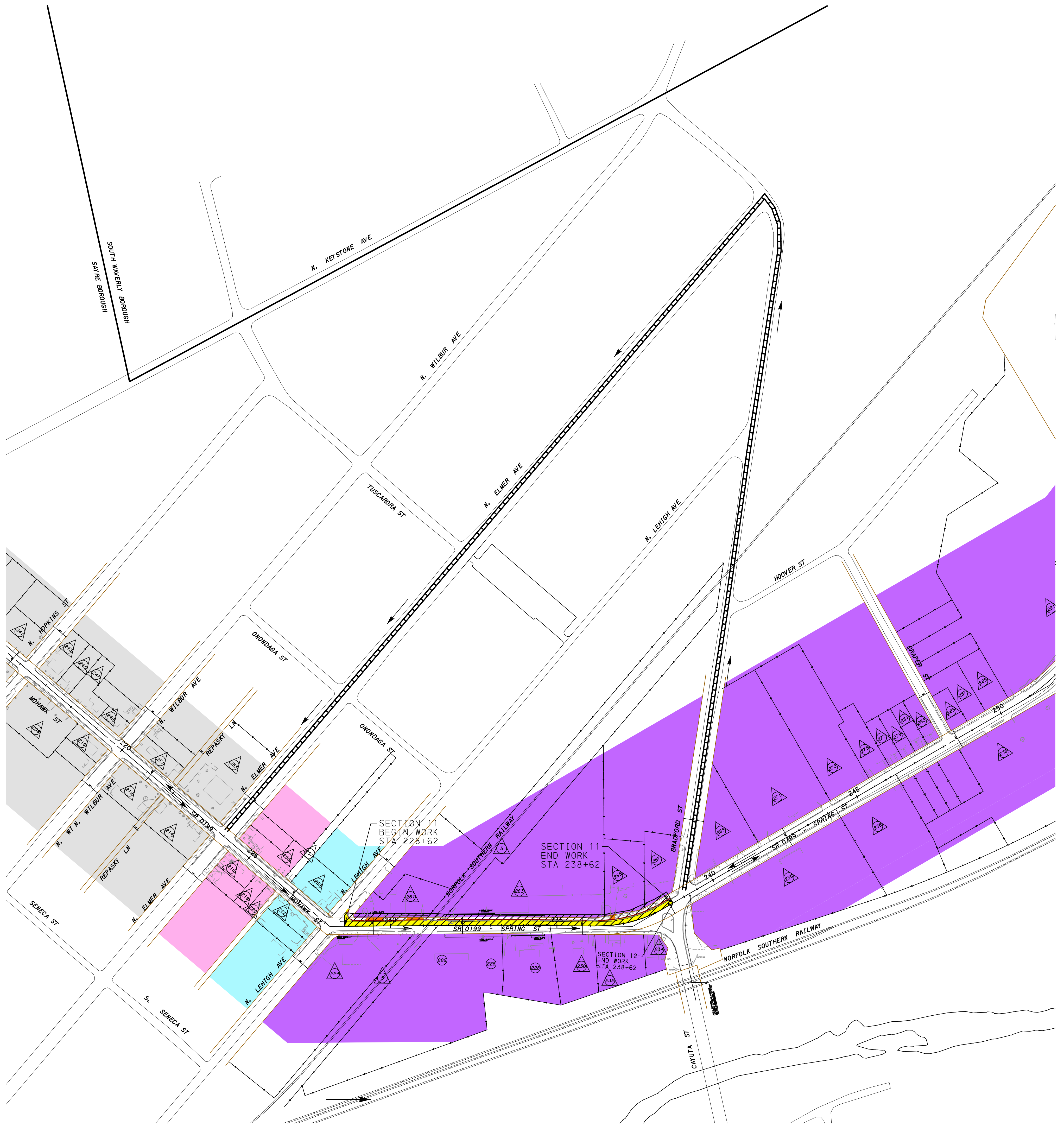
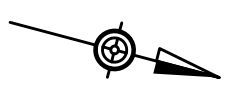

LEGEND

- | | | | | | | | |
|--|---|--|--------------------------|--|--------------------------|--|------------------------|
| | POST MOUNTED SIGN (TYPE B/TEMP) | | FLOW ARROW | | PUBLIC / EDUCATION USE | | SIDEWALKS |
| | SIGN ON TYPE III BARRICADE | | WORK AREA (HALF WIDTH) | | MULTI-FAMILY RESIDENTIAL | | ADA RAMPS |
| | SIGN ID | | WORK AREA (SHORT-TERM) | | HIGHWAY COMMERCIAL | | LEGAL RIGHT OF WAY |
| | EXTEND TYPE III BARRICADES ACROSS PORTION OF ROADWAY TO BE CLOSED | | LIGHT COMMERCIAL / MIXED | | ROADWAY RECONSTRUCTION | | TRAFFIC SIGNAL UPGRADE |
| | DETOUR ROUTE | | RESIDENTIAL | | DRIVEWAY ADJUSTMENTS | | |

SECTION 12 - NORTHBOUND
 STATION 238+62 TO STATION 255+12
 HALF WIDTH CONSTRUCTION
 DETOUR LENGTH - 3.47 MILES

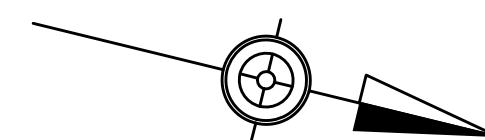

LEGEND

	POST MOUNTED SIGN (TYPE B/TEMP)		FLOW ARROW		PUBLIC / EDUCATION USE		SIDEWALKS
	SIGN ON TYPE III BARRICADE		WORK AREA (HALF WIDTH)		MULTI-FAMILY RESIDENTIAL		ADA RAMPS
	SIGN ID		WORK AREA (SHORT-TERM)		HIGHWAY COMMERCIAL		LEGAL RIGHT OF WAY
	EXTEND TYPE III BARRICADES ACCROSS PORTION OF ROADWAY TO BE CLOSED		LIGHT COMMERCIAL / MIXED		ROADWAY RECONSTRUCTION		TRAFFIC SIGNAL UPGRADE
	DETOUR ROUTE		RESIDENTIAL		DRIVEWAY ADJUSTMENTS		

SECTION 12 - SOUTHBOUND
 STATION 238+62 TO STATION 255+12
 HALF WIDTH CONSTRUCTION
 DETOUR LENGTH - 3.47 MILES

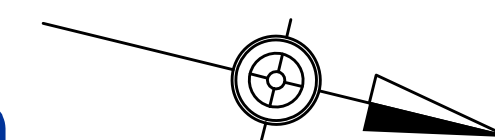

LEGEND

	POST MOUNTED SIGN (TYPE B/TEMP)		FLOW ARROW		PUBLIC / EDUCATION USE		SIDEWALKS
	SIGN ON TYPE III BARRICADE		WORK AREA (HALF WIDTH)		MULTI-FAMILY RESIDENTIAL		ADA RAMPS
	SIGN ID		WORK AREA (SHORT-TERM)		HIGHWAY COMMERCIAL		LEGAL RIGHT OF WAY
	EXTEND TYPE III BARRICADES ACCROSS PORTION OF ROADWAY TO BE CLOSED		LIGHT COMMERCIAL / MIXED		ROADWAY RECONSTRUCTION		TRAFFIC SIGNAL UPGRADE
	DETOUR ROUTE		RESIDENTIAL		DRIVEWAY ADJUSTMENTS		

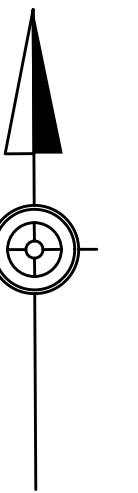

TRUCK DETOUR
DETOUR LENGTH - 7.09 MILES

NEW YORK

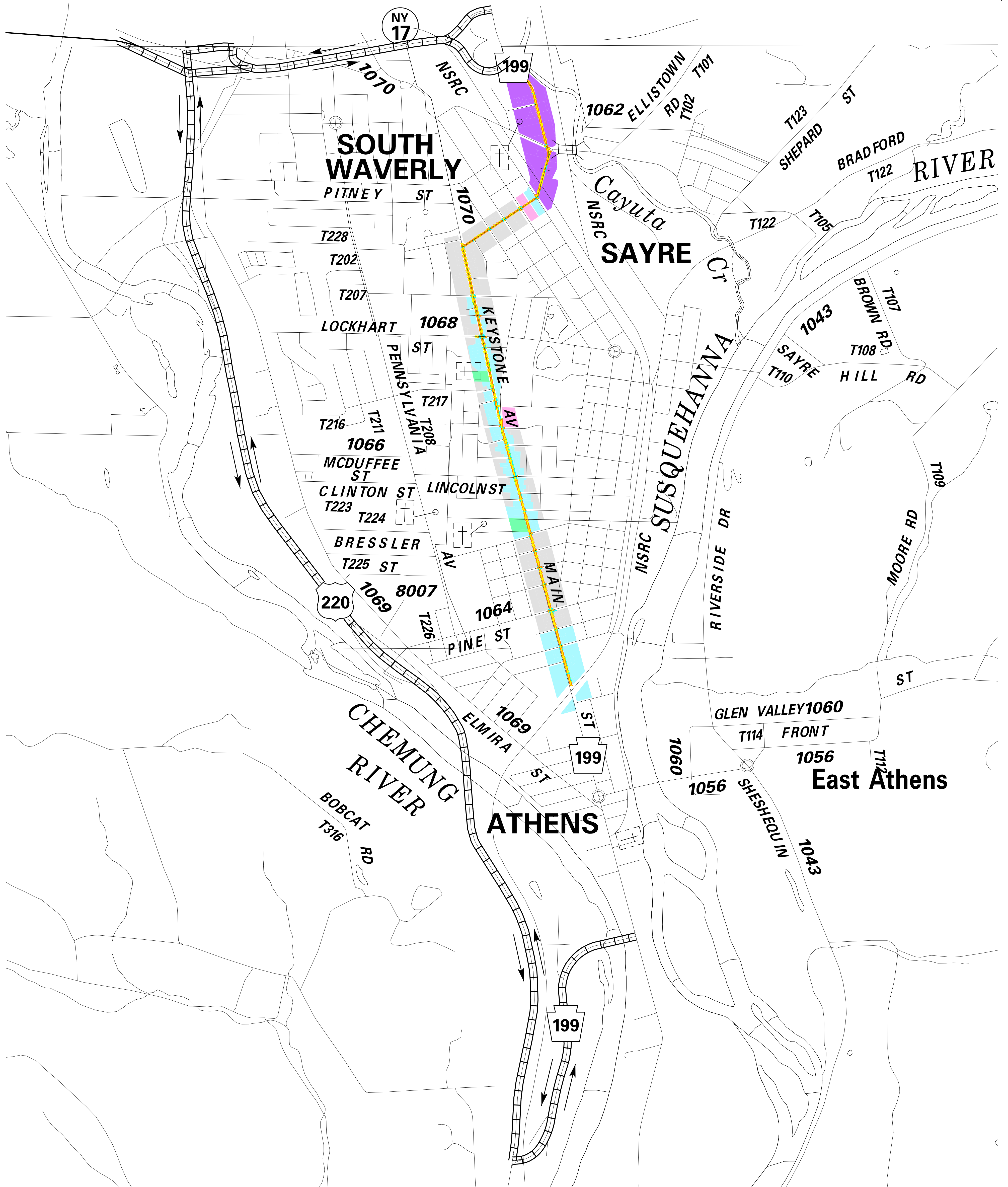

LEGEND

	POST MOUNTED SIGN (TYPE B/TEMP)		FLOW ARROW		PUBLIC / EDUCATION USE		SIDEWALKS
	SIGN ON TYPE III BARRICADE		WORK AREA (HALF WIDTH)		MULTI-FAMILY RESIDENTIAL		ADA RAMP
	SIGN ID		WORK AREA (SHORT-TERM)		HIGHWAY COMMERCIAL		LEGAL RIGHT OF WAY
	EXTEND TYPE III BARRICADES ACROSS PORTION OF ROADWAY TO BE CLOSED		LIGHT COMMERCIAL / MIXED		ROADWAY RECONSTRUCTION		TRAFFIC SIGNAL UPGRADE
	DETOUR ROUTE		RESIDENTIAL		DRIVEWAY ADJUSTMENTS		