

EAST HIGH STREET IMPROVEMENT PROJECT, MERCER COUNTY

PROJECT DESCRIPTION

The proposed project will include resurfacing of the existing roadway, drainage improvements, and provide pedestrians and bicyclists with a safer route through the project corridor that will include new “Share the Road” signage and pavement markings on East High Street in the Borough of Sharpsville, Mercer County.

The existing pavement is showing deterioration from heavy use. The stormwater systems are outdated. The bicycle and pedestrian traffic need safety enhancement. The current ADT is approximately 1,300 vehicles a day, on average, with 4% trucks. The roadway was last resurfaced (seal coated) in 2011.

PROJECT AREA

This project includes East High Street between North Walnut Street and Kelly Road Bridge in the Borough of Sharpsville, Mercer County.



ANTICIPATED CONSTRUCTION SCHEDULE

The project is anticipated to be Let in April 2024. Construction is anticipated for the 2024 construction season.

CONSTRUCTION FUNDING

The estimated construction cost for the project is \$430,000. The project will be funded with a combination of federal Surface Transportation Urban (STU) and local funds.

View *E. High Street Improvement Project* and complete the online comment at www.penndot.pa.gov/District1.

TRAFFIC IMPACTS

A detour will be required during construction and is expected to be in place for approximately 1 month. The proposed 0.4-mile detour route will be posted using East Shenango Street and North Walnut Street. Traffic will also be controlled by flaggers.

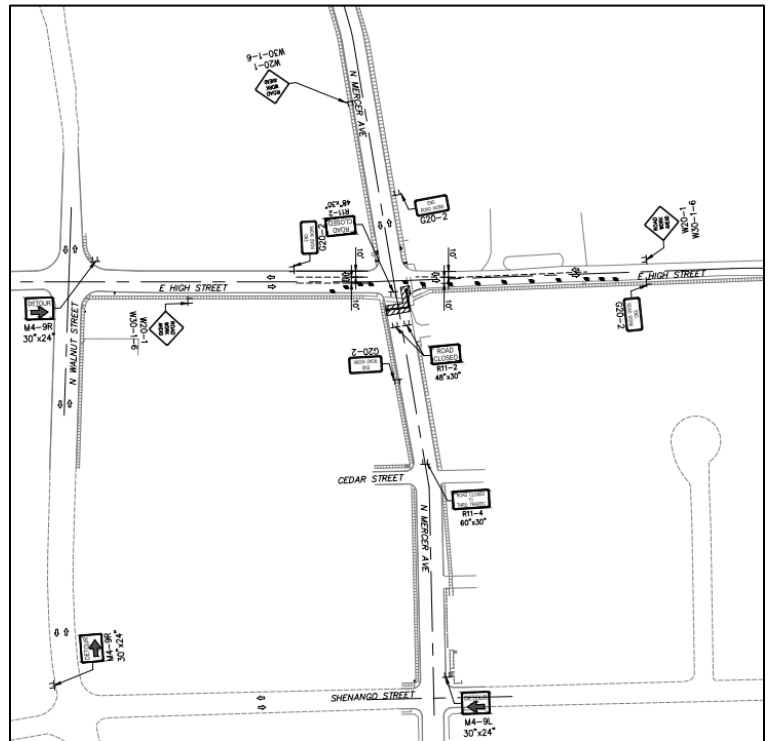

SECTION 4(F)

What is Section 4(f)?

Section 4(f) refers to the original section within the U.S. Department of Transportation (DOT) Act of 1966. Section 4(f) provides consideration to publicly owned park and recreation lands, wildlife and waterfowl refuges, and any publicly or privately owned historic sites listed on or eligible for listing on the National Register of Historic Places (NRHP). Section 4(f) applies to projects that receive funding from or require approval by an agency of the U.S. DOT.

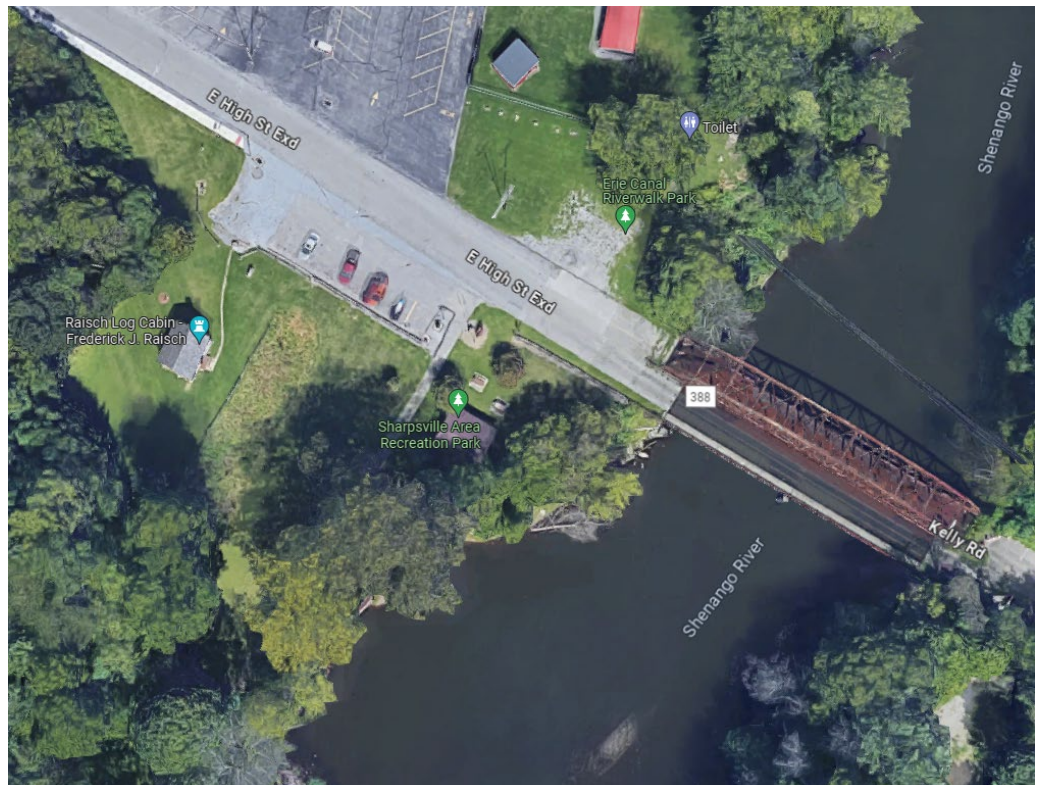

View E. High Street Improvement Project and complete the online comment at www.penndot.pa.gov/District1.

How does 4(f) Apply to this Project?

Two Section 4(f) resources have been identified within the project area: Sharpsville Area Recreation Park and Erie Canal Riverwalk Park.

Impacts to Section 4(f) Properties

Sharpsville Area Recreation Park and Erie Canal Riverwalk Park are both public parks located in the Sharpsville Borough on East High Street on the west side of the Kelly Road Bridge. The Sharpsville Area Recreation Park is currently used as a public park that includes a parking lot, green space, a pavilion and a pedestrian trail. The Erie Canal Riverwalk Park is a public park that includes a parking lot and pedestrian trail. Project construction will not result in any temporary or permanent impacts to Sharpsville Area Recreation Park or Erie Canal Riverwalk Park, and they will both remain open throughout construction.

CURRENT PUBLIC COMMENT PERIOD

The purpose of the public comment period is to introduce the project and receive input regarding any questions or concerns with the project. It is also an opportunity for the public to review and comment on the project's potential effect upon Cultural Resources pursuant to the Advisory Council on Historic Preservation's 36 CFR Part 800 regulations implementing Section 106 of the National Historic Preservation Act. The project documents can be made available in alternative languages or formats if requested.

Comments and questions can be submitted to PennDOT Project Manager Kyle Barker at kybarker@pa.gov or 814-678-7166, or 255 Elm Street, Oil City, PA 16301.